

A1RFRD10

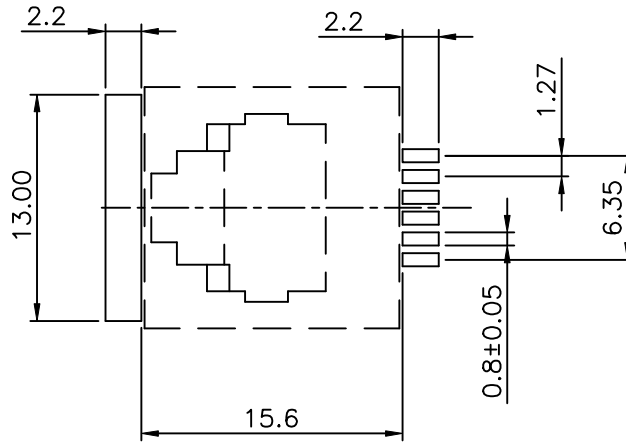

PC Board Layout
Component Side Shown

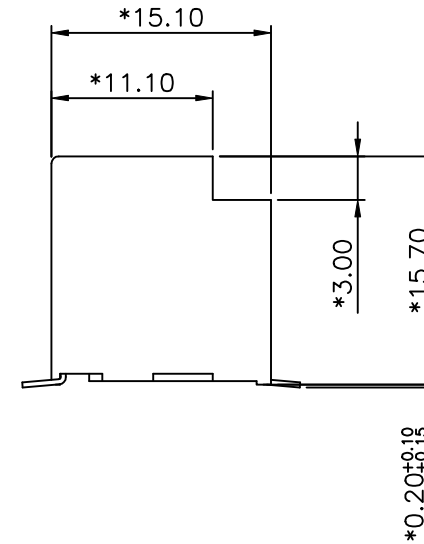
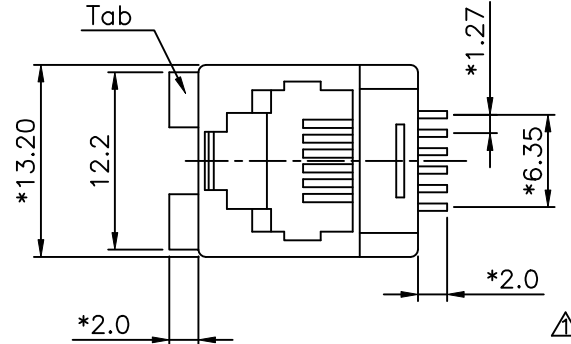

REVISION RECORD				
REV	ECO	DESCRIPTION	DRFT	CHKD
△		MODIFY DRAWING	YUNYU 12/28/00	
△		ADDPART NUMBER	CSH 8/17/03	
△		NOTES MODIFY	Among 11/01/04	

NOTES:

ELECTRICAL:

- VOLTAGE RATING : 125 VAC RMS.
- CURRENT RATING : 1.5 AMP.
- CONTACT RESISTANCE : 30 MILLIOHMS MAX.
- INSULATION RESISTANCE: 1000 MEGOHMS MIN @ 500 VDC.
- DIELECTRIC STRENGTH : 1000 VAC RMS 60Hz, 1MIN.

MECHANICAL:

- HOUSING MATERIAL : NYLON FR52 (HIGH TEMPERATURE) UL94V-0.
- CONTACT MATERIAL : PHOSPHOR BRONZE t=0.35mm.
- △ 3. PLATING : GOLD PLATING OVER NICKEL.
- OPERATING LIFE : 750 CYCLES MIN.
- PCB RETENTION PRE-SOLDER : 1 LB MIN.
- PCB RETENTION POST-SOLDER: 10 LBS MIN.

ENVIRONMENTAL:

- STORAGE : -40°C TO +85°C.
 - △ 2. OPERATION: -40°C TO +85°C.
- MATES WITH MODULAR PLUG CONFORMING TO
FCC PART 68, SUBPART F.

CUL FILE NO. E163191

PART NUMBER: E526X-700XB

- 4- 4CONTACTS
- 6- 6CONTACTS

- 1- 3u" 2- 6u" 3-15u"
- 4-30u" 5-50u"

- 7--PBT+15%
- B--FR52

DETACHED LISTS	← MM (INCH) →	DFTD Lien	DATE 12/10/99	FULL RISE ELECTRONIC CO., LTD		
	TOLERANCES EXCEPT AS NOTED	CHKD SAMMY	DATE 2004/11/17			
	MM	MFO	DATE	TITLE TOP ENTRY PCB JACK (SMT TYPE)		
	.0 ±0.20	APPVLLUSHENG	DATE 2004/11/17			
.00 ±0.15	MATERIAL :	QT'Y :	DRAWING NO. GE523A21		SIZE	REV
.000 ±0.075	ANGLES ±	FINISH :	/PART NO. SEE NOTE		A3	11/01/04
THIRD ANGLE PROJECTION	SCALE :	DO NOT SCALE DRAWING	SHEET X		OF Y	

8

7

6

5

4

3

2

1

H

G

F

E

D

C

B

A